

1-495-01~09

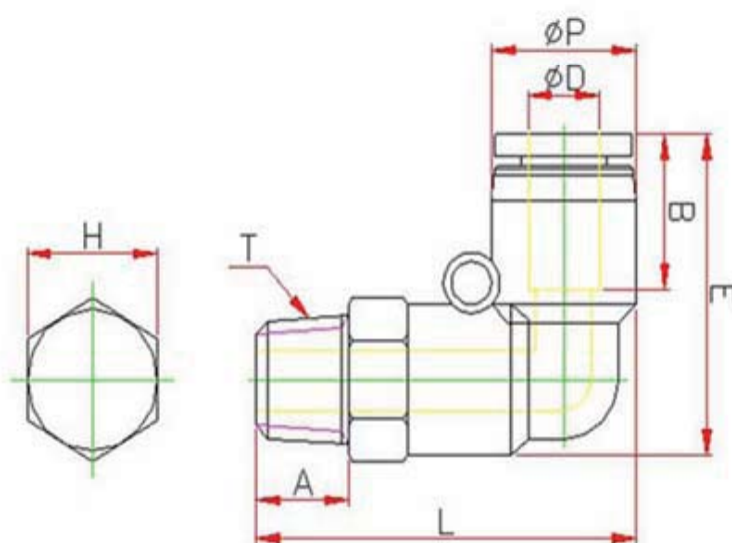

MODEL	ΦD	ΦP	T	L	E	A	B	H(Hex)	weight(g)
04-M5	4	10.5	M5*0.8p	26.4	22.5	4	15	10	7
04-01	4	10.5	R1/8	30	22.5	7.5	15	10	7.9
06-M5	6	13.1	M5*0.8p	31.8	27.3	4	15.5	12	10.5
06-01	6	13.1	R1/8	34.3	27.3	7.5	15.5	12	11
08-01	8	14.8	R1/8	37.8	30.5	7.5	17.8	14	15.4
08-02	8	14.8	R1/4	39.3	30.5	9	17.8	14	16.4
10-01	10	18.2	R1/8	43.3	36.5	7.5	20	17	26
10-02	10	18.2	R1/4	44.8	36.5	9	20	17	25.8
10-03	10	18.2	R3/8	44.8	36.5	9	20	17	26